

EDITION: 03/2010

# WINDOW AND DOOR SYSTEM 60T

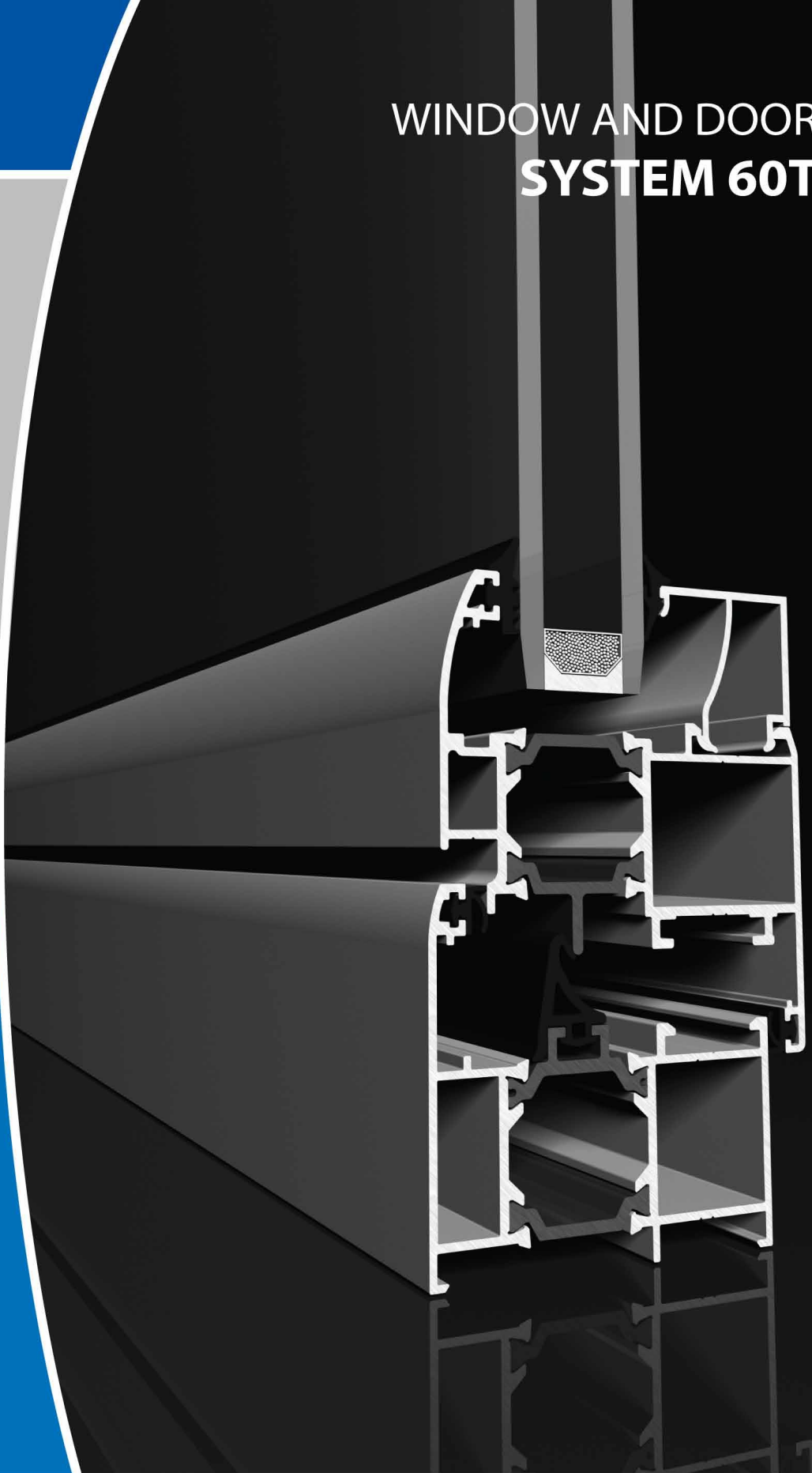

# WINDOW AND DOOR SYSTEM 60T



## TECHNICAL INFORMATIONS

### System Properties

- Modern Design
- Wall Thickness : 1.2 - 1.3 mm
- Frame Height : 60 mm
- Vent Height : 65 mm
- Insulation Bar : 24 mm
- Safety Drainage System
- EPDM Gaskets
- Glazing From 10 mm to 34 mm
- Multilock Section
- Thermal Permeability : (Uf) 2.58 W /m2K

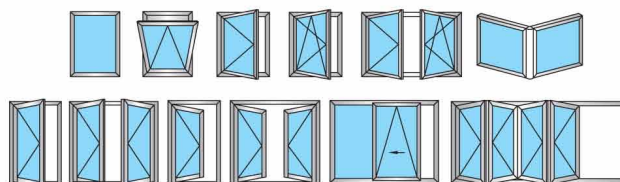

### 60T ALUminium

Euro Groove 1

### 60T PERImetric

- Perimetric Groove suitable for 9 axis and 20 mm hinge mounting dimension
- 09-156-00 extruded joint is suitable for GU unijet - D and Aubi A300

### Code Logic

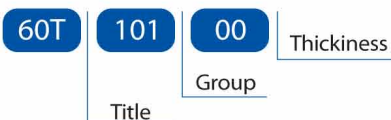

### Titles

- 60T - System Name
- 07 - Alternative Adaptors
- 08 - Glazing Beats
- 09 - Extruded Corner Joints

### Groups

- 101, 102,... - Frames
- 201, 251,... - Vents
- 301, 302,... - Mullions
- 401, 402,... - Kick Plates and Adaptors
- 501, 502,... - Adaptors

### Alloy

The alloys of the aluminium profiles are 6060 and 6063 (AlMgSi 0,5 - F22 ) based on EN 12020-2 / 755-9 standards

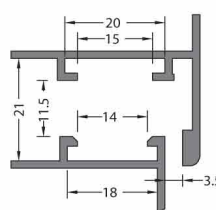
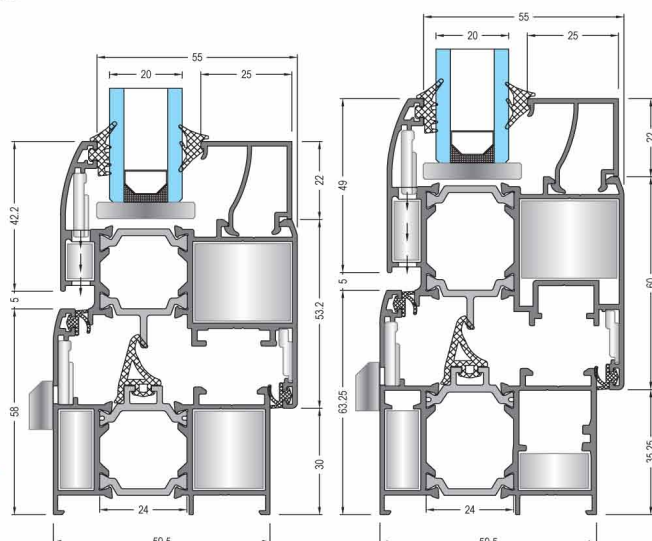

Euro Groove Section 1

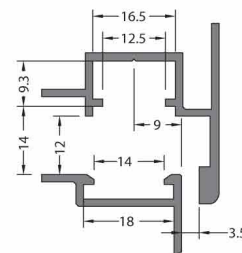

Perimetric Section