

EDITION / VERSİYON
05/2017

SLIDING SYSTEM
SÜRME SİSTEMİ

SYSTEM 30C
SİSTEM 30C



 **Lorenzoline**[®]
aluminium profile system

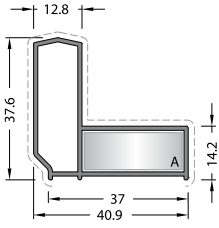

CODE / KOD
30C-101-11

EXTRUDED CORNER JOINT
KÖŞE TAKOZU



A CC-101-26.5

THEORETICAL WEIGHT kg/m
TEORİK AĞIRLIK kg/m
0.474

DIE-CAST CORNER JOINT
DÖKÜM BAĞLANTI



A LC-1127

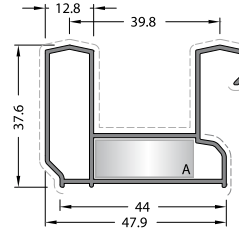

CODE / KOD
30C-102-11

EXTRUDED CORNER JOINT
KÖŞE TAKOZU



A CC-101-26.5

DIE-CAST CORNER JOINT
DÖKÜM BAĞLANTI



A LC-1127

THEORETICAL WEIGHT kg/m
TEORİK AĞIRLIK kg/m
0.642

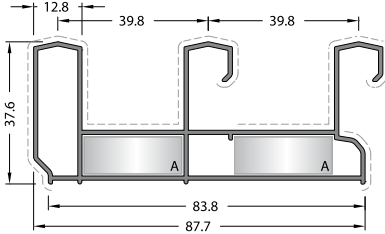

CODE / KOD
30C-103-11

EXTRUDED CORNER JOINT
KÖŞE TAKOZU



A CC-101-26.5

THEORETICAL WEIGHT kg/m
TEORİK AĞIRLIK kg/m
1.050

DIE-CAST CORNER JOINT
DÖKÜM BAĞLANTI



A LC-1127

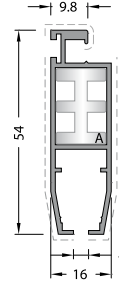

CODE / KOD
1621

THEORETICAL WEIGHT kg/m
TEORİK AĞIRLIK kg/m
0.498

EXTRUDED CORNER JOINT
KÖŞE TAKOZU



A ZM-13

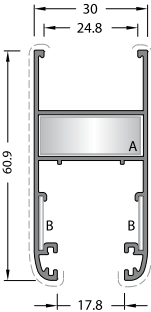

CODE / KOD
30C-201-11

THEORETICAL WEIGHT kg/m
TEORİK AĞIRLIK kg/m
0.662

EXTRUDED CORNER JOINT
KÖŞE TAKOZU



A CC-101-26.5



MK-20.1

DIE-CAST CORNER JOINT
DÖKÜM BAĞLANTI



A LC-1127

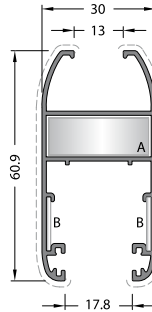

CODE / KOD
30C-202-11

THEORETICAL WEIGHT kg/m
TEORİK AĞIRLIK kg/m
0.674

EXTRUDED CORNER JOINT
KÖŞE TAKOZU



A CC-101-26.5



MK-20.1

DIE-CAST CORNER JOINT
DÖKÜM BAĞLANTI



A LC-1127

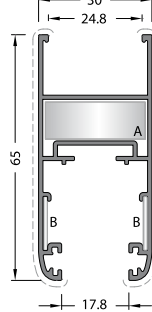

CODE / KOD
30C-203-11

THEORETICAL WEIGHT kg/m
TEORİK AĞIRLIK kg/m
0.736

EXTRUDED CORNER JOINT
KÖŞE TAKOZU



A CC-101-26.5



MK-20.1

DIE-CAST CORNER JOINT
DÖKÜM BAĞLANTI



A LC-1127

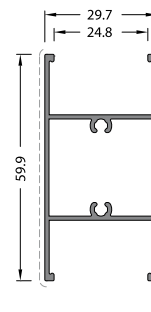

CODE / KOD
30C-301-11

THEORETICAL WEIGHT kg/m
TEORİK AĞIRLIK kg/m
0.604

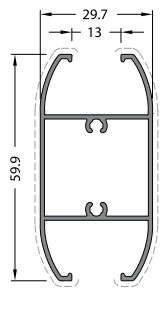

CODE / KOD
30C-302-11

THEORETICAL WEIGHT kg/m
TEORİK AĞIRLIK kg/m
0.629

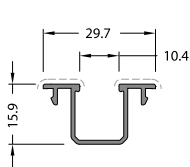

CODE / KOD
30C-401-11

THEORETICAL WEIGHT kg/m
TEORİK AĞIRLIK kg/m
0.208

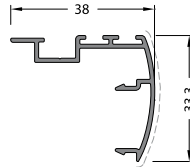

CODE / KOD
30C-402-11

THEORETICAL WEIGHT kg/m
TEORİK AĞIRLIK kg/m
0.307

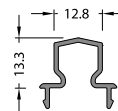

CODE / KOD
30C-403-11

THEORETICAL WEIGHT kg/m
TEORİK AĞIRLIK kg/m
0.177

No Visible Surface
Görünen Yüzey Yoktur

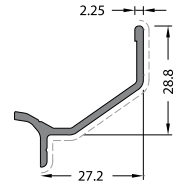

CODE / KOD
30C-501-00

THEORETICAL WEIGHT kg/m
TEORİK AĞIRLIK kg/m
0.310

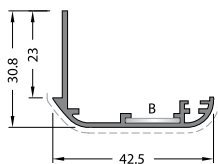

CODE / KOD
07-102-00

EXTRUDED CORNER JOINT
KÖŞE TAKOZU



MK-20.1

THEORETICAL WEIGHT kg/m
TEORİK AĞIRLIK kg/m
0.324

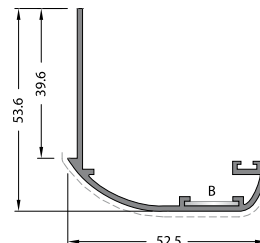

CODE / KOD
07-103-00

EXTRUDED CORNER JOINT
KÖŞE TAKOZU



MK-20.1

THEORETICAL WEIGHT kg/m
TEORİK AĞIRLIK kg/m
0.488

GASKETS / FİTİLLER

CODE KOD	DRAWING ÇİZİM	APPLICATION UYGULAMA	DESCRIPTION AÇIKLAMA	THEORETICAL WEIGHT kg/m TEORİK AĞIRLIK	PACKAGE QUANTITY PAKET MİKTARI
EM1-01			Glazing Gasket Inside (EPDM) İç Cam Fıtlı	0.040	375m
EM1-02			Glazing Gasket Inside (EPDM) İç Cam Fıtlı	0.050	300m
EM1-03			Glazing Gasket Inside (EPDM) İç Cam Fıtlı	0.060	250m
EM1-04			Glazing Gasket Inside (EPDM) İç Cam Fıtlı	0.070	215m
EM2-01			Glazing Gasket Outside (EPDM) Dış Cam Fıtlı	0.052	285m
PB7-3P-550			5.5 mm Brush 5.5 mm Fırça	0.004	1400m
PB7-3P-800			8 mm Brush 8 mm Fırça	0.006	900m

CORNER JOINTS / KÖŞE BAĞLANTILAR

CODE KOD	DRAWING ÇİZİM	APPLICATION PROFILES ÇALIŞTIĞI PROFİL	APPLICATION DETAIL UYGULAMA DETAYI
LC-1127		30C-101-11 30C-102-11 30C-103-11 30C-201-11 30C-202-11 30C-203-11	
MK-20.1		30C-201-11 30C-202-11 30C-203-11 07-102-00 07-103-00	

PRESS CORNER JOINTS / PRES KÖŞE BAĞLANTILAR

CODE KOD	DRAWING ÇİZİM	PROFILE CODE PROFİL KODU	QUANTITY MIKTAR	CUTTING SIZE KESİM ÖLÇÜSÜ	APPLICATION PROFILES ÇALIŞTIĞI PROFİL	APPLICATION DETAIL UYGULAMA DETAYI
CC-101-26.5		09-101-00	75 Pieces Adet	26.5mm	30C-101-11 30C-102-11 30C-103-11 30C-201-11 30C-202-11 30C-203-11	

ACCESSORIES / AKSESUARLAR

CODE KOD	DRAWING ÇİZİM	DESCRIPTION AÇIKLAMA	APPLICATION DETAIL UYGULAMA DETAYI
EM-0101		Pulley With One Wheel Tekli Sürme Rulman	
EM-0204		Pulley With Two Wheel Çiftli Sürme Rulman	
ZM-0330		Sash Stopper Kanat Stoper	
ZM-07		Central Seal Hava Kesici	
EM30C-402		Adapter Cap Adaptör Kapağı	
ZM-10		Frame Stopper Kasa Stoper	
ZM-11		Fixed Sash Accessories Sabit Kanat Mesafe Takozu	
ZM-13		Flyscreen Corner Joint Sineklik Plastik Köşe	
ZM-20		Flyscreen Pulley Sineklik Rulman	
EM10-01 (White / Beyaz)		Drainage Cap Tahliye Kapağı	
EM10-02 (Black / Siyah)			
EM10-03 (Brown / Kahverengi)			
EM10-04 (Gray / Gri)			
EM10-05 (L.Caffe / A.Kahve)			

GLAZING COMBINATIONS / CAM KOMBİNASYONLARI

GLAZING THICKNESS CAM KALINLIĞI	GLAZING GASKET INSIDE İÇ CAM FİTLİ	GLAZING GASKET OUTSIDE DİŞ CAM FİTLİ	ADAPTER ADAPTER
4 mm	EM1-02	EM1-02	30C-401-11
6 mm	EM1-01	EM1-01	
4 mm	EM1-03	EM1-04	-
6 mm	EM1-03	EM1-02	-
17mm	EM1-03	EM1-03	-
20mm	EM1-01	EM1-01	-

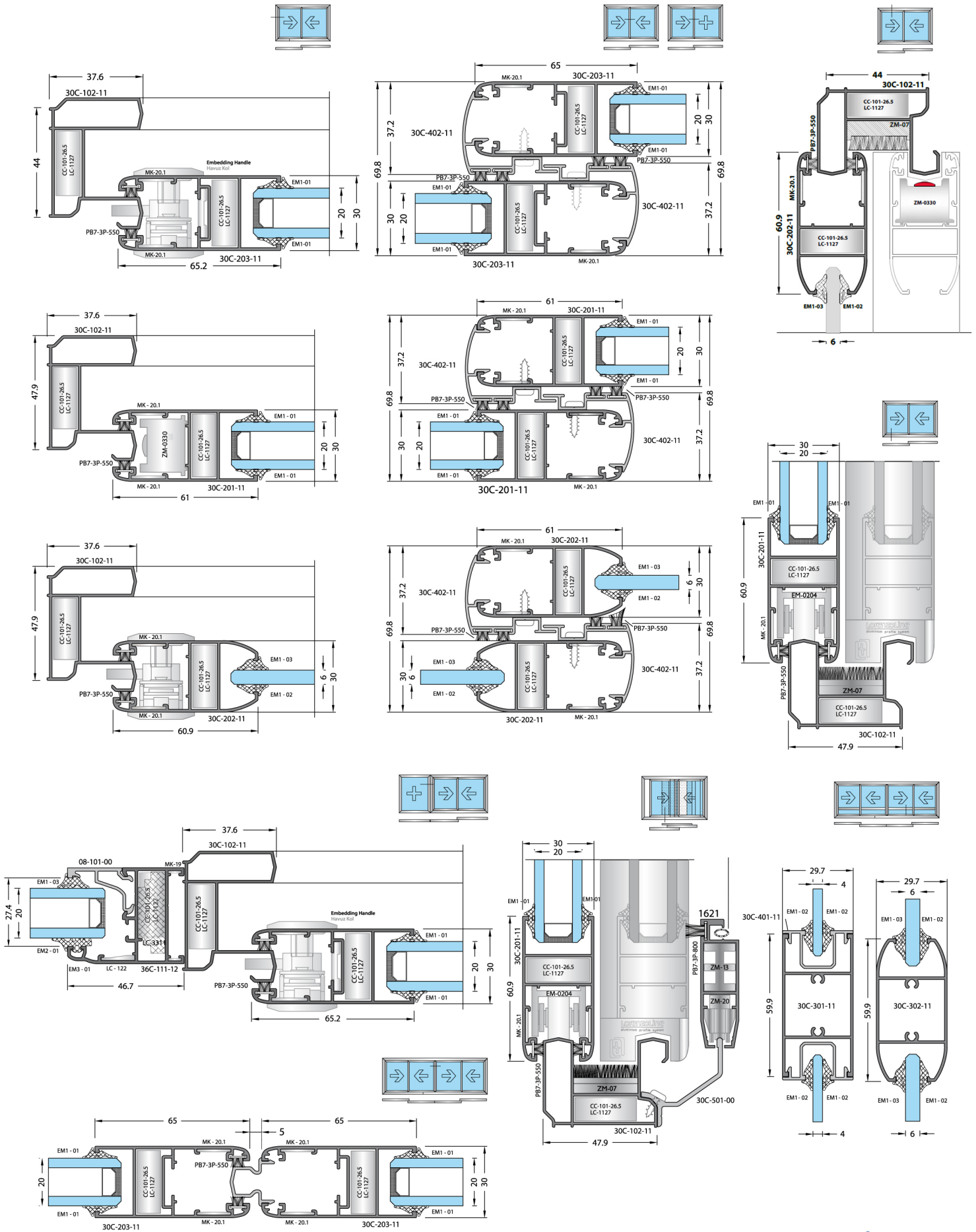

SLIDING SYSTEM SÜRME SİSTEMİ

SYSTEM 30C SİSTEM 30C



TECHNICAL INFORMATIONS / TEKNİK AÇIKLAMALAR

System Properties / Sistem Özellikleri

- Modern Design / Modern Dizayn
- Vent Height / Kanat Genişliği :30 mm
- Safety Drainage System / Güvenli Tahliye Sistemi
- EPDM Gaskets / EPDM Fital
- Glazing From 4 -6 mm to 17 -20 mm
- Cam Kullanımı 4 -6 mm'den 17-20 mm

Code Logic / Kod Mantığı

30C	101	11
Factory Standard Fabrika Standartı		
Group / Grup		

Title / Seri

Titles / Seriler

- 30C System Name / 30C Sistem Adı
- 09 - Extruded Corner Joints / Pres Köşe Takozu

Groups / Gruplar

- 101 , 102 , ... - Frames / Kasalar
- 201 , 211 , ... - Vents / Kanatlar
- 501 , 502 , ... - Adaptors / Adaptörler

Alloy / Alaşım

The alloys of the aluminium profiles are 6060 and 6063 (AlMgSi 0,5 – F22) based on EN 12020-2 / 755-9 standarts
Alüminyum profil alaşımları 6060 ve 6063 (AlMgSi 0,5 - F22) EN 12020-2 / 755-9 standartlarına uygundur.

Sliding Opportunities Sürme Seçenekleri

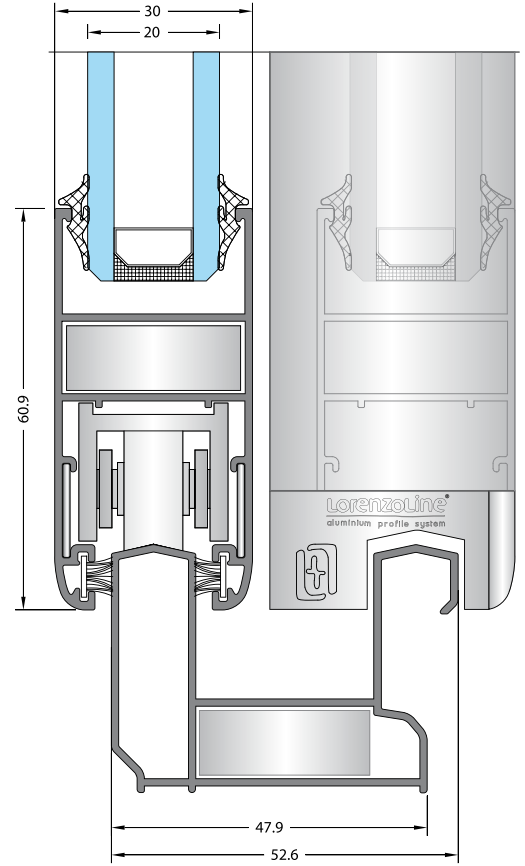
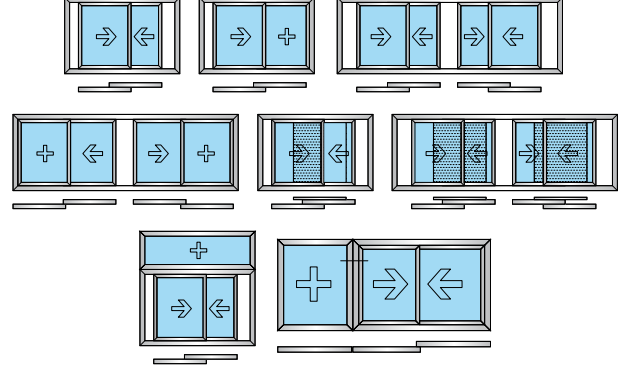

*All drawings are not scaled.
Tüm çizimler ölçeksizdir.*

Lorenzoline
aluminium profile system



Produced by 